



Part Number/Price

Ref#	Part#	Description	Price
1	Consult	Plate A, SQ 093-1627-11	Consult
2	Consult	Spring, B, 2 072-5389-14	Consult
3	Consult	Slide, rail, left 075-5713-01	Consult
4	Consult	Bracket, stopper 093-5279-13	Consult
5	Consult	Bracket, head 066-4253-18	Consult
6	Consult	Shaft, printer, slide 072-5495-16	Consult
7	Consult	Bracket AS, print 093-5278-38	Consult
8	Consult	Slide, rail, right, 075-5712-07	Consult
9	Consult	Bracket, sensor, 075-5718-09	Consult
10	Consult	Bracket, motor, 072-8512-17	Consult
11	Consult	Plate A, sensor, 072-8513-20	Consult
12	Consult	Block B, sensor, 074-7263-11	Consult
14	Consult	Frame, rear, 072-8517-15	Consult
15	Consult	Sensor, receiver, 075-5706-13	Consult
16	Consult	Cover, rear, 072-8519-31	Consult
17	Consult	Base, under, 121-5397-06	Consult
18	Consult	Frame, middle, 079-8650-28	Consult
19	Consult	Frame, right, 079-1433-02	Consult
20	Consult	Bracket, AS, display, 090-0585-04	Consult
22	Consult	Frame, AS, upper 090-0563-11	Consult
23	Consult	Frame, left 079-1440-09	Consult
25	Consult	Bracket, thermal harness, 079-1441-11	Consult
26	Consult	Bracket, display board, 079-1437-07	Consult
28	Consult	L plate A, micro sw 079-8652-07	Consult
29	Consult	Clip, print, 074-0827-42	Consult
30	Consult	Cover, harness, thermal 079-1442-06	Consult
31	Consult	Plate A, key 079-8653-01	Consult
32	Consult	Base, key, 079-1438-01	Consult
33	Consult	Plate A, cover, lower 074-7025-11	Consult
34	Consult	Collar, 074-7026-05	Consult
35	Consult	Bracket, stopper 075-5705-01	Consult
36	Consult	Cover, printer, connector 079-1439-04	Consult
37	Consult	Gear, flat, 047-0630-04	Consult
38	Consult	Rail, slide, 043-1905-02	Consult
40	Consult	Plate A, spring, support 066-4250-08	Consult
41	Consult	Stay, head, thermal 066-4261-09	Consult
42	Consult	Bush, 066-7780-06	Consult
43	96440	Cover, head 075-5776-14	Consult
44	96435	Spring, coil, compressive 096-9830-03	Consult
45	96436	Spring, coil, compressive 096-9831-07	Consult
46	Consult	Rubber pad, 072-8631-08	Consult
47	Consult	Accessory, bush, 046-2004-02	Consult
48	110644	Spring, coil, tension 021-5673-01	Consult
49	Consult	Accessory, bush, cable 123-2319-09	Consult
50	Consult	PWB accessory, collar, bush 000-1973-08	Consult
51	Consult	PWB accessory, collar, bush, 000-1845-04	Consult
52	Consult	Accessory, fastener, edge saddle 064-0360-05	Consult
54	Consult	Accessory, clamp, flat cable 065-1823-03	Consult
57	Consult	Catch, magnet, 079-1224-01	Consult
58	Consult	Cover, slot, CF 117-9863-04	Consult

(Diagram IL-EMZ-A)

Parts not listed are no longer available. Some parts listed may not be available.

An ISO 9001 registered company ©2021 Rice Lake Weighing Systems 09/21 Prices and specifications subject to change without notice. Visit ricelake.com for current prices.

IL-EMZ

Main Unit

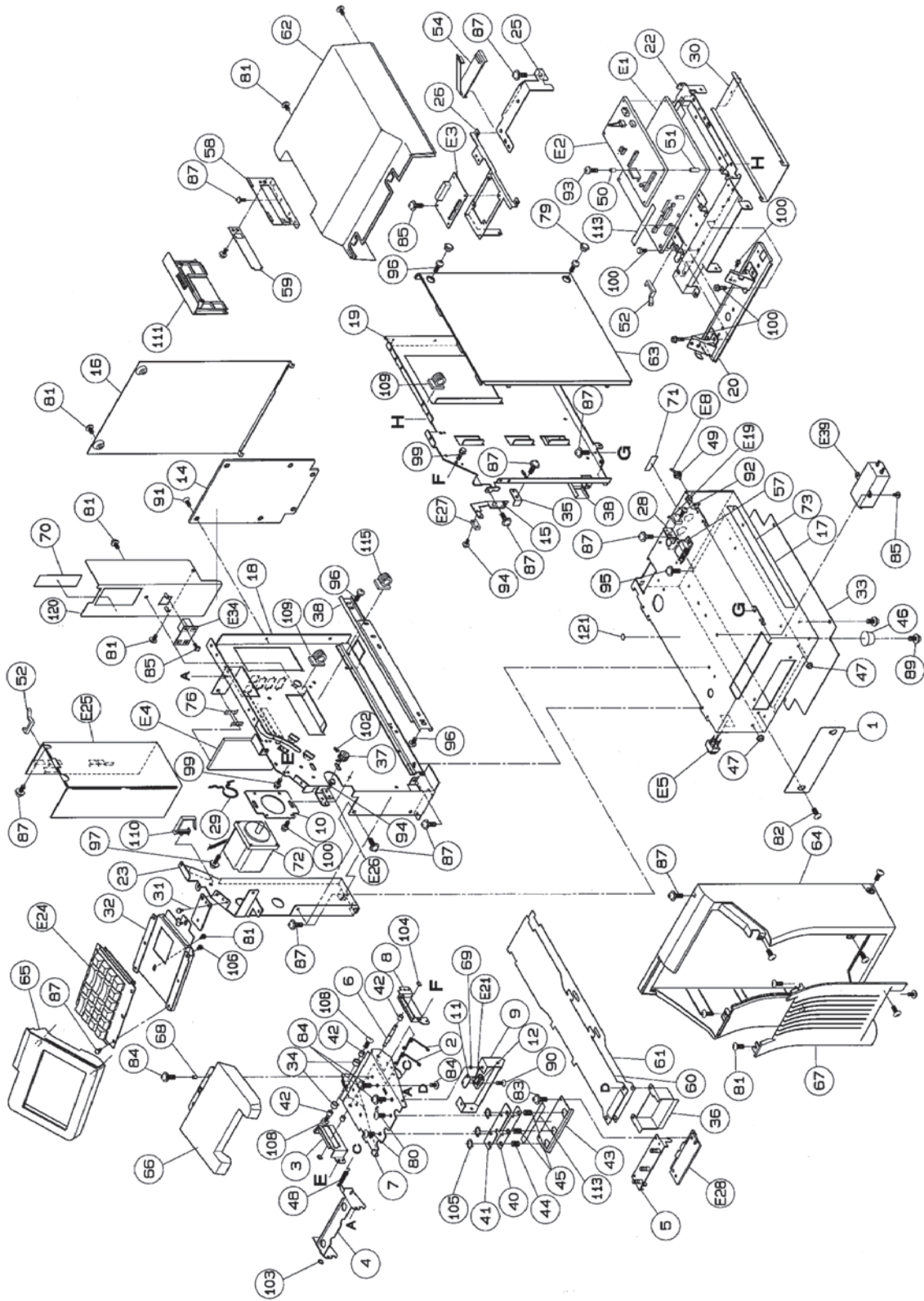

NOTE: For diagram numbers beginning with "E" refer to IL-EMZ main electrical Unit.

IL-EMZ-A

Discontinued Scales



Part Number/Price

Ref#	Part#	Description	Price
59	Consult	Plate B, PC, 066-1831-01	Consult
60	Consult	Sheet, harness, upper 074-7032-17	Consult
61	Consult	Sheet, harness, lower 079-8651-03	Consult
62	Consult	Case, main body, upper 072-8684-14	Consult
63	Consult	Case, main body, side 072-8698-16	Consult
64	Consult	Case, main body, front 072-8838-20	Consult
65	Consult	Case, key, 072-8867-28	Consult
66	Consult	Cover, printer, 072-8852-22	Consult
67	Consult	Cover, cassette, front 072-8841-21	Consult
68	Consult	Collar, spacer 010-5999-08	Consult
69	Consult	Collar, spacer 010-5543-03	Consult
70	Consult	Nameplate, explanation, 104-2220-03	Consult
71	Consult	Nameplate, explanation, 122-1731-00	Consult
72	Consult	Motor AS, stepping, 074-7420-19	Consult
73	Consult	Nameplate, specification, 123-5573-28	Consult
76	Consult	PWB accessory, card spacer, 000-1805-05	Consult
79	Consult	Cap, 001-4457-01	Consult
80	Consult	Screw, cross truss, 002-1925-03	Consult
81	Consult	Screw, cross truss, 000-0237-06	Consult
82	Consult	Screw, cross truss, 001-0022-00	Consult
83	Consult	TP screw, 010-0725-06	Consult
84	Consult	TP tapping screw, 000-0436-01	Consult
85	Consult	TP screw M3x6 000-0438-08	Consult
87	Consult	TP screw, 000-0439-01	Consult
89	Consult	Screw, cross truss, 000-0254-00	Consult
90	Consult	Screw, cross flat, 000-0217-01	Consult
91	Consult	Screw, cross flat, 002-1914-02	Consult
92	Consult	Screw, cross pan head, 066-4172-01	Consult
93	Consult	Screw, cross pan head, 002-1835-01	Consult
94	Consult	Screw, cross pan head, 002-1850-08	Consult
95	Consult	Screw, cross pan head, BWA S2P2 000-0323-03	Consult
96	Consult	Screw, cross pan head, 000-0091-00	Consult
97	Consult	Screw, cross pan head, BWA S2P1 003-2571-00	Consult
99	Consult	Cross head, hex bolt with sw/pw 014-3996-09	Consult
100	Consult	Plus hex bolt, 000-0337-05	Consult
102	Consult	Set screw, hex socket, w-point 000-0469-03	Consult
103	Consult	E-ring, 000-0286-09	Consult
104	Consult	E-ring, 000-0287-02	Consult
105	47215	C ring, for shaft, 036-0949-05	Consult
106	200473	TP tapping screw, T2 019-8842-03	Consult
108	Consult	Screw, cross truss, 007-1060-09	Consult
109	Consult	Accessory, clamp, CKN clamp 002-5032-02	Consult
110	Consult	Accessory, clamp, LWS clamp 051-3041-07	Consult
111	Consult	Cover, card, 071-4684-12	Consult
113	Consult	Tape rejection 079-8656-01	Consult
115	Consult	Accessory, clamp, CKN clamp 007-5412-01	Consult
120	Consult	L plate B, 095-9478-17	Consult
121	Consult	Nameplate, 097-8992-07	Consult

(Diagram IL-EMZ-A)

Parts not listed are no longer available. Some parts listed may not be available.

An ISO 9001 registered company ©2021 Rice Lake Weighing Systems 09/21 Prices and specifications subject to change without notice. Visit ricelake.com for current prices.

IL-EMZ
Main Unit

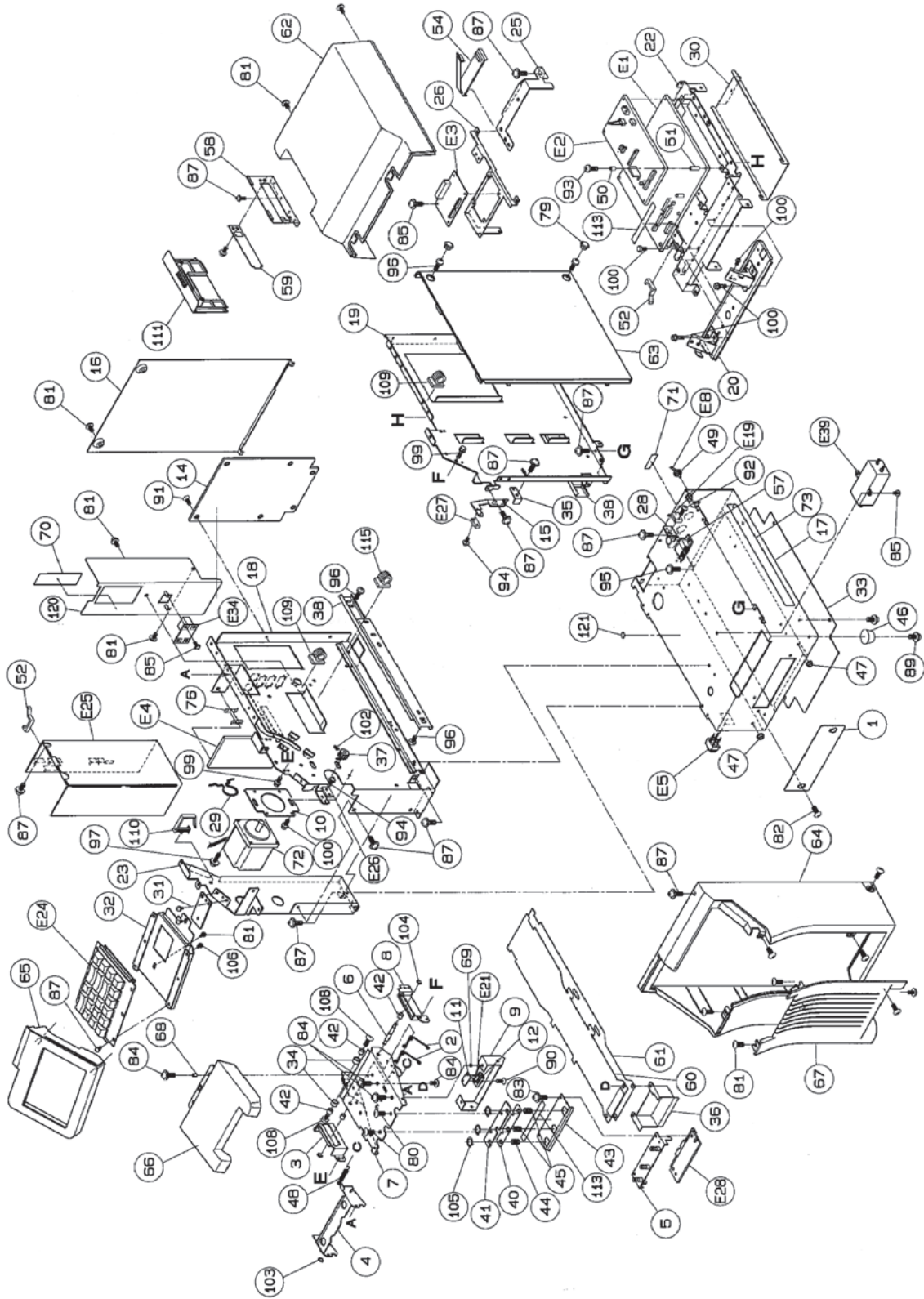

NOTE: For diagram numbers beginning with "E" refer to IL-EMZ main electrical Unit.

IL-EMZ-A

Discontinued Scales