

# 880/880 Plus Performance™ Series

Programmable Digital Weight Indicator/Controller



880 Plus Universal



880 Panel Mount

Board information:  
Previous version green CPU board is 127 mm (5.0 in) wide  
Current version blue CPU board is 140 mm (5.5 in) wide

## Standard Features

- LED display, 14 mm, six-digit, 14-segment
- RS-232 or RS-485 serial port
- USB device port connects directly to a PC
- Ethernet TCP/IP polled or continuous
- AC or DC models
- Built-in DIN-rail clips on controller box (panel mount)
- Display and controller can be separated up to 75 m (panel mount)
- Hardware slot for one option card
- Operator functions through menu key for audit trail, preset tare, accumulator, time & date and setpoints
- Audit trail tracking for configuration and calibration changes. Password protection for user and configuration changes.
- 20 setpoints with latched batch engine or unlatched outputs
- Four onboard digital I/O channels
- Programmable ticket formats up to 1.000 characters for header text, gross, net, accumulator and setpoints
- Local/remote operation
- Multi-range or multi-interval weighing
- Filter settings for light, medium and heavy noise

### Options/Accessories

- Metrological hardware sealing kit
- Adapter plate for converting 310A and 520 panel mounts
- Panel mount kit for universal enclosure

## Specification Options

### Analog Output:

16-bit resolution, 0-10 VDC, 0-20 mA, 4-20 mA

### Relay Board:

Four dry contact relays; DC Max: 30 VDC at 3 amps; AC max: 250 VAC at 3 amps per contact

### EtherNet/IP Interface:

According to EN 50325-2

### Profinet Interface:

According to IEC 61784 (CPF-3/3)

### Modbus/TCP Interface:

Up to 8 bytes of I/O data, 100 Mbps full duplex Ethernet

### Profibus DP Interface:

According to EN 50170

### EtherCAT

According to IEEE 802.3

Additional models are available with the approvals shown below.  
Please consult the factory for part numbers.

## Specifications

### Power:

Line voltages: 100-240 VAC  
Frequency: 50-60 Hz  
DC voltages: 12-24 VDC  
Power consumption: AC: 15 W, DC: 20 W

### Excitation Voltage:

10 VDC, 16 x 350 Ω or 32 x 700 Ω load cells

### Analog Signal Input Range:

-45 to 45 mV

### Analog Signal Sensitivity:

0,3 μV/graduation minimum at 7,5 Hz;  
1,0 μV/graduation recommended

### A/D Sample Rate:

7,5 to 960 Hz, software selectable

### Resolution:

Internal: 8 million counts/8.000.000 23 bit  
Display: 999.999

### System Linearity:

± 0,01% full scale

### Digital I/O:

Four I/O onboard (max), primary keys, pseudo functions, batching functions

### Communication Ports:

RS-232 full duplex or RS-485 half duplex; USB micro A/B connector 2.0; Ethernet TCP/IP

### Status Annunciators:

Gross, net, center of zero, standstill, lb, kg, tare, preset tare, multi-range/interval 1/2/3

### Display:

LED, 14 mm, six-digit, 14-segment with decimal or comma

### Keys/Buttons:

Membrane panel, tactile feel

### Temperature Range:

Certified: -10°C to 40°C  
Operating: -10°C to 50°C

### Dimensions (W x H x D):

Panel: 152 mm x 102 mm x 126 mm  
Universal: 251 mm x 238 mm x 110 mm

### Weight:

Panel: 1 kg;  
Universal: 5 kg

### Rating/Material:

Display bezel NEMA Type 4X, Type 12, and IP69K  
Panel display: stainless steel  
Controller box: aluminum  
Universal: stainless steel

### Warranty:

Two-year limited warranty

### EMC Immunity:

EN 50082 Part 2 IEC EN 61000-4-2, 3, 4, 5, 6, 8, and 11

### Approvals:

NTEP CC 13-080 Class III/IIIL, 10.000d  
Measurement Canada AM-5931C Class III/IIILD, 10.000d  
OIML R76/1992-GB1-04,02 Class III, 10.000d  
EU Test Certificate TC8463  
UL/cUL Listed (universal)  
UL/cUL Recognized (panel mount)  
CE Marked

## Approvals



Measurement  
Canada  
Approved



LISTED



us

us

us

us

us

us

us

us

us

us

us

us

us

us

us

us

us

us

us

us

us

us

us

us

us

us

us

us

us

us

us

us

us

us

us

us

us

us

us

us

us

us

us

us

us

us

us

us

us

us

us

us

us

us

us

us

us

us

us

us

us

us

us

us

us

us

us

us

us

us

us

us

us

us

us

us

us

us

us

us

us

us

us

us

us

us

us

us

us

us

us

us

us

us

us

us

us

us

us

us

us

us

us

us

us

us

us

us

us

us

us

us

us

us

us

us

us

us

us

us

us

us

us

us

us

us

us

us

us

us

us

us

us

us

us

us

us

us

us

us

us

us

us

us

us

us

us

us

us

us

us

us

us

us

us

us

us

us

us

us

us

us

us

us

us

us

us

us

us

us

us

us

us

us

us

us

us

us

us

us

us

us

us

us

us

us

us

us

us

us

us

us

us

us

us

us

us

us

us

us

us

us

# 880/880 Plus Performance™ Series

Digital Weight Indicator/Controllers

## Part Number/Price

Part #	Description	Est. Weight	Price
<b>880 Panel Mount AC Powered</b>			
151674*	Display only	1 kg	Consult
177977*	115-230VAC, controller only	2 kg	Consult
177976*	115-230VAC, without installed option	2 kg	Consult
177979*	115-230VAC with analog output	2 kg	Consult
177980*	115-230VAC with relay board	2 kg	Consult
177982*	115-230VAC with EtherNet/IP	2 kg	Consult
177983*	115-230VAC with ProfiNet	2 kg	Consult
177984*	115-230VAC with Modbus/TCP	2 kg	Consult
177985*	115-230VAC with Profibus DP	2 kg	Consult
179155*	115-230VAC with EtherCAT	2 kg	Consult
<b>880 Panel Mount DC Powered</b>			
177987*	12-24VDC, without installed option	2 kg	Consult
177988*	12-24VDC controller only	2 kg	Consult
<b>880 Plus Universal AC Powered</b>			
177990 ††	115-230VAC, without installed option	4 kg	Consult
178497 ††	115-230VAC with analog	4 kg	Consult
178497 ††	115-230VAC, with relay board	4 kg	Consult
<b>880 Plus Universal DC Powered</b>			
178495	12-24VDC, without installed option	4 kg	Consult

\*Power cable not included



†† CEE 7/7 plug (Euro)

## Options/Accessories

Part #	Description	Price
<b>Option Cards (5.5 in CPU only)</b>		
179156	Analog output, 0-10VDC, 0-20 mA, 4-20 mA	Consult
179157	Relay board, four dry contact outputs	Consult
<b>Network Cards</b>		
179158	EtherCAT interface	Consult
179159	EtherNet/IP® interface	Consult
179160	ProfiNet® interface	Consult
179161	Modbus/TCP® interface	Consult
179163	Profibus DP interface	Consult
<b>Hardware</b>		
153660	Metrological sealing kit	Consult
158404	Adapter plate for IQ310 and 520 replacement	Consult
101923	Relay box enclosure, does not include relay	Consult
177850	Panel mount kit for universal enclosure	Consult
15436	Power cord, pigtail with US NEMA 5-15 plug	Consult
105382	Power cord, pigtail with Euro Plug CEE 7/7	Consult
<b>Cables</b>		
152434	Cable, USB A to micro A shielded, 2 meters	Consult
156817	Cable, Ethernet TCP/IP CAT.5E shielded RoHS compliant blue RJ45 connectors 1 meter	Consult
156818	Cable, Ethernet TCP/IP CAT.5E shielded RoHS compliant blue RJ45 connectors 3 meters	Consult
156821	Cable, Ethernet TCP/IP CAT.5E shielded RoHS compliant blue RJ45 connectors 5 meters	Consult
<b>Manuals and Software</b>		
77925	Revolution™ scale software	Consult
152240	Operators manual	Consult
158387	Technical manual	Consult

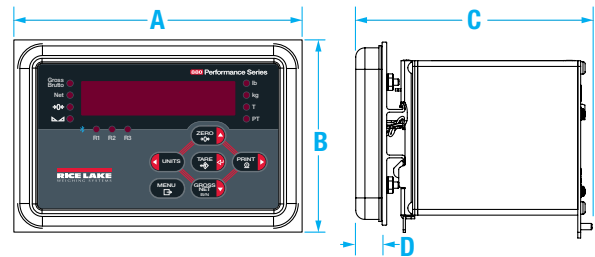

### 880 Panel Mount Dimensions

A	152 mm	C	126 mm
B	102 mm	D	14 mm BEZEL DEPTH

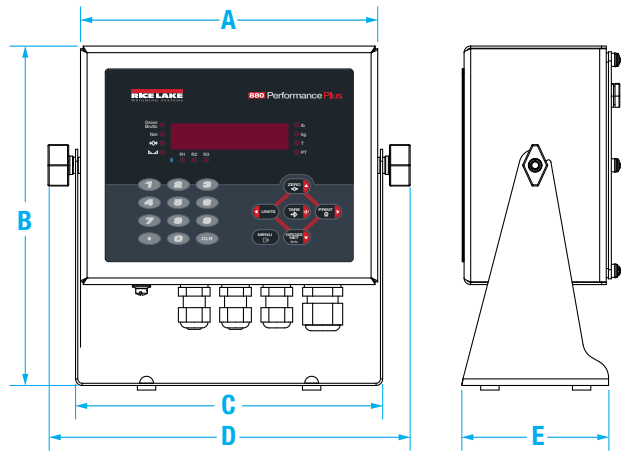

### 880 Universal Dimensions

A	206 mm	D	248 mm
B	235 mm	E	102 mm
C	213 mm		

## Options/Accessories

Part #	Description	Price
<b>Primary Component Parts (5.5 in CPU only)</b>		
131740	Overlay, panel mount, six-key	Consult
163986	Overlay, universal with numeric keypad	Consult
131598	Display board	Consult
175603 *	Power supply, 100-240 VAC	Consult
175604 *	Power supply, 12-24VDC	Consult
175109 *	CPU board	Consult

\* Design change in 2017 to 140 mm wide controller, see replacement parts catalog for the 127 mm wide boards.